

## Review Article

# Roles of Light-Harvesting Complex Stress-Related Proteins in the Stress Responses of *Chlamydomonas*

Menglin Shi<sup>1</sup>, Lin Zhou<sup>1</sup>, Meijie Cui<sup>1</sup>, Tongling Ge<sup>1</sup>, Fangjian Chen<sup>2</sup>, Lei Zhao<sup>1,3,\*</sup>

<sup>1</sup>Key Laboratory of Systems Microbial Biotechnology, Tianjin Institute of Industrial Biotechnology, Chinese Academy of Sciences, Tianjin, China

<sup>2</sup>Tianjin Key Laboratory for Industrial Biological Systems and Bioprocessing Engineering, Tianjin Institute of Industrial Biotechnology, Chinese Academy of Sciences, Tianjin, China

<sup>3</sup>National Center of Technology Innovation for Synthetic Biology, Tianjin, China

### Email address:

shiml@tib.cas.cn (Menglin Shi), zhoulin@tib.cas.cn (Lin Zhou), cuimj@tib.cas.cn (Meijie Cui), getl@tib.cas.cn (Tongling Ge), chen\_fj@tib.cas.cn (Fangjian Chen), zhaol@tib.cas.cn (Lei Zhao)

\*Corresponding author

### To cite this article:

Menglin Shi, Lin Zhou, Meijie Cui, Tongling Ge, Fangjian Chen, Lei Zhao. Roles of Light-Harvesting Complex Stress-Related Proteins in the Stress Responses of *Chlamydomonas*. *Journal of Plant Sciences*. Vol. 10, No. 1, 2022, pp. 1-11. doi: 10.11648/j.jps.20221001.11

Received: December 14, 2021; Accepted: December 30, 2021; Published: January 8, 2022

**Abstract:** Light is very important for photosynthesis in plants. However, excess light can result in photodamage to the photosynthetic apparatus. Via nonphotochemical quenching (NPQ), the oxidative stress caused by excess light energy can be counteracted by photoprotective mechanisms that evolve photosynthetic/oxygenic organisms. Energy-dependent quenching (qE), as the major NPQ component, relies on the accumulation of specific proteins that are termed light-harvesting complex stress-related (LHCSR) proteins in microalgae and mosses. LHCSRs have been reported to participate in adaptation to diverse environmental stresses, including excess light. In this review, we discuss the identification of LHCSRs in *Chlamydomonas* and the basic biochemical properties and functions of LHCSRs in acclimation to environmental stresses such as excess light and salt stress. We further review the potential interactive factors and upstream regulators of LHCSRs in *Chlamydomonas*, aiming to explore the underlying mechanism of LHCSRs in adaptation to multiple environmental stresses. We also discuss the evolution of LHCSRs in green algae and mosses and tentatively speculate about their participation in the adaptation to environmental change of the Earth. Work on *Chlamydomonas* LHCSR could provide clues to analyze the roles of LHCSR in both green algae and mosses. Thus, we offer an overview of current knowledge on the characteristics and functions of *Chlamydomonas* LHCSRs, which could shed new light on their detailed studies in both green algae and moss in the future.

**Keywords:** *Chlamydomonas*, LHCSR, Adaptation, Environmental Stress, Evolution

## 1. Introduction

Algae, unicellular organisms with no roots and other nonphotosynthetic organs, are very efficient in converting solar energy into biomass. Although higher plants and microalgae share the same basic functions of photosynthesis [1], microalgae do not need arable soils for their growth and have no competitive relation with food crops. Microalgae are highly rich in lipids, and over 50% of their dry biomass is lipids [2]. However, the use of microalgae to produce biomass remains limited, reducing cost-effectiveness.

Microalgae have low light utilization efficiency due to energy dissipation at high solar energy. Although the maximal theoretical efficiency of photosynthetically active radiation (PAR, 400-700 nm) solar energy conversion to biomass is approximately 27%, the actual efficiency of solar energy conversion to biomass in laboratory-scale growth tests is less than 6% [3]. One of the most important reasons is the uneven distribution of light in algal culture. Insufficient light into cells in the deeper layers results in respiratory loss, while photoinhibition occurs in surface cells exposed to strong light [4]. Excess light induces photoprotective mechanisms via

nonphotochemical quenching (NPQ), which relies on light-harvesting complex stress-related (LHCSR) proteins in microalgae. To provide a whole picture of LHCSRs in acclimation to environmental stress, we will review the recent progress on their biochemical characteristics, functions and underlying regulatory mechanisms in *Chlamydomonas*.

LHCSRs are widely distributed in most algae and mosses but absent in higher plants [5]. Here, we also analyze the distribution and evolutionary relationship of LHCSRs in green algae and moss, aiming to trace their conserved functions.

Based on these results, we present the future prospects of studies on acclimation to environmental stress fulfilled by LHCSRs, which may be applied in food crop resistance in the future.

## 2. Photoprotective Systems in Microalgae

Light is essential for photosynthesis. Previous studies indicate that a considerable amount of light-harvesting complex (LHC) proteins play important roles in light harvesting [6]. Three helices contained in LHC proteins are typically thylakoid transmembrane and bind lipid molecules, chlorophyll, and carotenoids [7]. Although photosynthesis depends on light, excess light could cause overexcitation of the photosynthetic apparatus and then produce highly active molecules or byproducts that could damage microalgae [8].

Fortunately, a variety of photoprotective mechanisms have been developed in microalgae to relieve photodamage, among which NPQ of chlorophyll (Chl) *a* fluorescence plays the most important role. In contrast to the inherent NPQ in higher plants, NPQ is manifested as a result of acclimation in *Chlamydomonas* under high light conditions [9]. The transcript of the *LI818* gene, which encodes LHCSR proteins, is a mRNA induced by light [10]. The expression pattern of *LI818* is different from those of most of any other genes encoding LHCs [11], which suggests its functions in addition to light harvesting. Since then, a series of studies have demonstrated that LHCSRs mainly function in the photoprotection process in microalgae exposed to excess light [12]. In contrast to photosystem II subunit S (PsbS), which is employed to activate NPQ in higher plants, LHCSRs are adopted in the same process by microalgae [5, 13]. Although PsbS has also been identified in microalgae, it is not as important for the protection of the photosynthetic apparatus as in higher plants but important for the transient response to high light [14].

In *Chlamydomonas*, the family of LHCSRs is composed of LHCSR1 and LHCSR3, which are encoded by *LHCSR1* (Cre08.g365900) and *LHCSR3.1* (Cre08.g367500) \ *LHCSR3.2* (Cre08.g367400), respectively. The *Chlamydomonas npq4* mutant was screened out using chlorophyll fluorescence. LHCSR3.1 and LHCSR3.2 were initially identified to be responsible for the energy-dependent quenching (qE)-deficient phenotype [9]. With the mutation of a homologous gene, *LHCSR1*, in the *npq4* background, qE was completely inactivated in the *Chlamydomonas* triple mutant [5]. This evidence supports the possibility of the

functions of *LHCSR1*, *LHCSR3.1* and *LHCSR3.2* in photoprotection.

Further studies indicate that the transcripts of *LHCSRs* accumulate in cells under photooxidative stress, including excess light [15], CO<sub>2</sub> [16], sulfur [17] or iron [18] deprivation, suggesting their roles in acclimation to environmental stress. Detailed studies have revealed that the polypeptide sequences of *LHCSR3.1* and *LHCSR3.2* are identical, but they have different promoter sequences and 3'UTR regions, demonstrating their different regulatory mechanisms to adapt to stress [19]. More interestingly, although the 3D structures of LHCSR1 and LHCSR3 are very similar (Figures 2A, B, C), LHCSR1 is reported to have a weaker quenching ability than LHCSR3, possibly because of their different binding sites with L2 carotenoids [20], suggesting their different biochemical activities.

## 3. Nonphotochemical Quenching and Its Components

Plants are exposed to different amounts of light in different environments. Algae live in water with a lack of ultraviolet, red and an abundance of blue wavelengths. Algae grown in aquatic environments are usually exposed to low light conditions, and fluctuating light may bring photoinhibition. [21].

Excess light triggers many quenching reactions of chlorophyll fluorescence, and more reactions could be uncovered with the development of capture and detection technology in the future. NPQ, as the major and fastest form of chlorophyll fluorescence-quenching reactions, mainly occurs within the antenna system of photosystem II. LHCSRs are the most important parts of microalgae (Figure 1A). NPQ is comprised of several components, and they are reported to have different degrees of importance depending on the microalgae species and physiological states. There are several steps in NPQ, including qE (fast phase), qZ and qT (middle phase), and qI (slow phase) [22]. Among them, qE is the most unique component of NPQ [23], can be activated reversibly within seconds along with light intensity and has the highest quenching ability.

In higher plants, qE is combined with a quenching component that is zeaxanthin dependent and triggered by low lumenal pH [24]. Zeaxanthin is the enhancer of qE, which can also be triggered by low lumenal pH. The initial synthesis of zeaxanthin originates from violaxanthin de-epoxidase activation, which is located in the lumen. The V1 site and L2 site of LHCII have the ability to bind newly synthesized zeaxanthin [25-29]. After exposure to low light, zeaxanthin is catalyzed back to violaxanthin by zeaxanthin epoxidase [30]. Then, qE is triggered by the specific amino acid protonation of acidified photosystem II (PSII) proteins that are exposed to the thylakoid lumen.

Photosynthetic organisms contain several xanthophyll cycles, including the lutein epoxide cycle, diadinoxanthin cycle and violaxanthin cycle. The lutein epoxide cycle only exists in some higher plant families. The diadinoxanthin cycle mainly exists in

species such as Bacillariophyceae, Xanthophyceae, Haptophyceae, and Dinophyceae. The violaxanthin cycle of brown algae and green algae is the same as that of higher plants [31]. However, the relationship between the violaxanthin cycle and NPQ in algae varies with species. For example, the NPQ of *Chlorella vulgaris*, *Chlorella saccharophila* and *Bracteacoccus minor* was dependent on zeaxanthin, while the violaxanthin de-epoxidation of *Pedinomonas minor*, *Tetracystis aeria* and *Chlamydomonas* was not closely associated with NPQ [32, 33].

The activation mechanisms of qE are not fully conserved among species, which makes species-specific responsiveness dependent on both the protonation of responsive PSII proteins and the involvement of the xanthophyll cycle [5, 13]. PsbS was reported to be responsible for qE activation in vascular plants two decades ago [13], and LHCSR3s confer the same function in microalgae [5]. Interestingly, both LHCSR3s and PsbS are active in qE in *Physcomitrella patens*, which diverged early from the green algae to the higher plant [34].

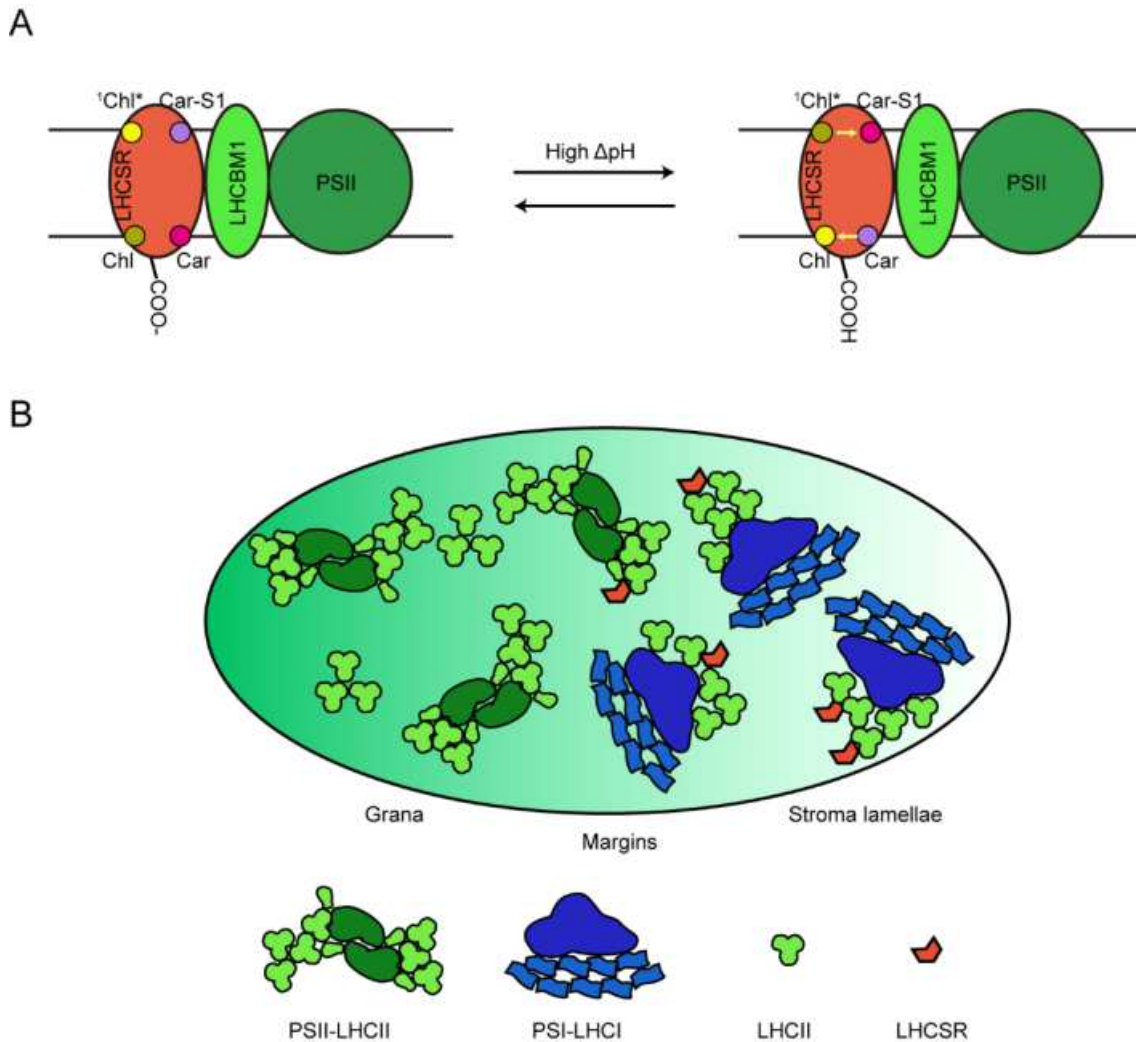

**Figure 1.** Model for qE in microalgae. Schematic of LHCSR-dependent NPQ in *Chlamydomonas reinhardtii*. Energy transfer to the S1 state of carotenoids and electron transfer from carotenoids to chlorophyll are enhanced under high light conditions, and epoxidation reactions are reversed under limited light. LHCBM1 is proposed to be an LHCSR docking site. This picture is modified from Niyogi and Truong (2013) [35]. (B) Microalgae model of PSI and PSII fluorescence quenching dependent on LHCSR. No clear boundary among grana, margins, and stromal thylakoids is observed in algal chloroplasts. LHCSR3s participate in the dissipation of excess energy in both PSII and PSI by quenching the associated LHCII antenna. This picture is modified from Pinnola (2019) [36].

#### 4. LHCSR3s and Their Biochemical Characteristics in Microalgae

LHCSR3s participate in the initial activation of qE in microalgae [5, 9]. However, it is difficult to isolate grana domains of unicellular algae, so the LHCSR3 location is still unclear [37]. It is speculated that LHCSR3s independently catalyze the quenching of PSI-LHCI-LHCII complexes (in stroma-exposed domains)

and PSII-LHCII (in grana membranes). This mechanism maintained the plastoquinone redox poise and controlled both PSI and PSII antenna system excitation in the short of far-red absorption forms of PSI (Figure 1B).

The binding of LHCSR3 to PSI or PSII is modulated by light conditions in *Chlamydomonas* [37, 38]. Energy transfer to the S1 state of carotenoids and electron transfer from carotenoids to chlorophyll are enhanced under low pH conditions (Figure 1A) [39]. LHCSR3 may act as an energy

quencher considering that it could bind pigments and has a state transition with a short fluorescence lifetime [9, 40]. The dissipative states are reversibly activated at low pH, which enables organisms to adapt to stepwise changes in solar irradiance. Moreover, LHCSR3 loss causes an increase in the *Chl a/Chl b* ratio, indicating that some reconfiguration occurs in the antenna [5].

The LHCSR1 conformation that controls the transition changes rapidly between dissipative states. [41]. The LHCSR1 lifespan of the quenched conformations is 80 ps, and the unquenched conformation is 3.7 ns, indicating that unquenched LHCSR1 only acts as a regular light-catching antenna but competes with excitation trapping in the quenching state [42].

Thus, this evidence supports that multiple biochemical characteristics of LHCSRs make them respond to possible environmental stress in microalgae.

## 5. LHCSRs Play Roles in Acclimation to Environmental Stresses

LHCSRs were first identified in mutant screening in which strains were exposed to high light [5], indicating that LHCSRs could be induced by such stress. Joliot and Finazzi further demonstrated the possible mechanism: the Calvin cycle is saturated, resulting in the lack of both ADP and PI under high light conditions. Thus, the activity of ATPase is progressively inhibited, leading to the accumulation of  $H^+$  and a decreased pH value in the stroma, and low pH further induces qE [43].

Intensive studies provide clues on the characteristics of LHCSRs in response to excess light. Similar to known LHC proteins, LHCSRs are embedded into the thylakoid membrane [20]. Unlike PsbS, LHCSRs form complexes with *Chl a*, *Chl b*, lutein and Vio/Zea [9].

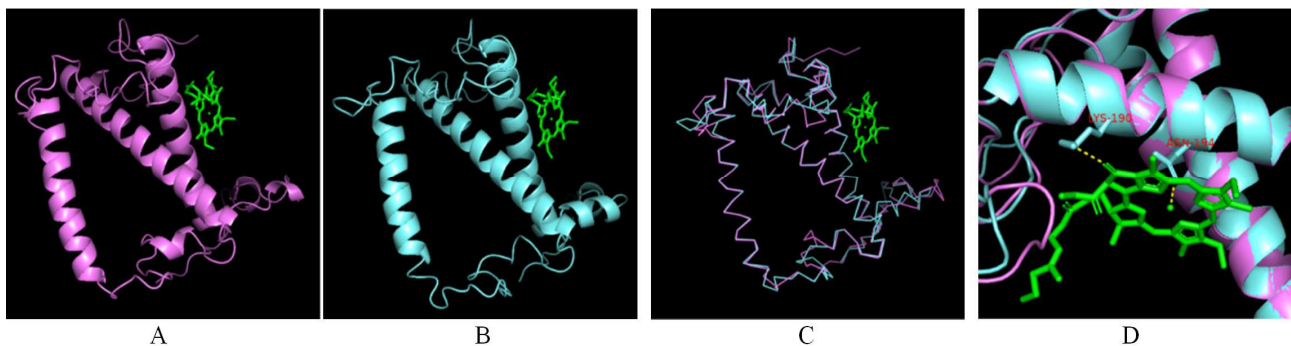

**Figure 2.** Model structure of LHCSR1 and LHCSR3. Structural model of LHCSR3 obtained by sequence alignment with *Chl a/b* binding protein (PDB 6zzx.1.T). (B) Structural model of LHCSR1 obtained by sequence alignment with *Chl a/b* binding protein (PDB 6zzy.1.S). (C) Structural alignment of LHCSR3 (violet) and LHCSR1 (cyan). (D) Enlargement of the *Chl a* binding site region with the LYS-190 and ASN-194 residues predicted in LHCSRs to be in close contact with the *Chl a* molecule. Molecular graphics was performed with PyMOL software.

3D model prediction of LHCSR proteins confirms that they can bind to *Chl a*, and the binding sites are LYS-190 and ASN-194. Unlike most LHC proteins, the site selectivity of LHCSRs is less strict, and other pigment-specific binding sites of LHCSRs could not be confirmed (Figure 2D).

LHCSRs respond to low pH depending on the exposure of their glutamate/aspartate residues to the cavity [9, 44]. Biochemical and spectral analysis showed that as pH-sensitive proteins, <sup>1</sup> *Chl*\*-binding LHCSRs could be catalytically decomposed and quenched under acidic conditions, and the excitation energy could be quenched by the charge transfer mechanism of photosynthetic pigments [20].

Unlike most of the LHC proteins, the lifetime of chlorophyll fluorescence of LHCSRs is unusually not very long and even shorter under low pH conditions, indicating that the protein adopts active energy-dissipation mechanisms that make it suitable for the transfer between proton sensing and quenching reactions. The active energy dissipation mechanism of LHCSR allows quenching to be active even under limited illumination conditions, and the quenching activity may be enhanced by acidic residue protonation of the protein. Therefore, the expression of LHCSR is usually kept at a low level under limited light conditions to avoid unnecessary quenching reactions [9, 45, 46]. Based on the quenching

characteristics of the LHCSR3 subunit mentioned above, scientists have proposed a variety of underlying mechanisms, including energy transference of carotenoids, formation of carotenoid radical cations, carotenoid-chlorophyll charge transfer, and the induction of chlorophyll-chlorophyll charge transfer [39].

In addition to the quenching effect of the PSII antenna, LHCSRs also catalyze the quenching of PSI by affecting PSI-related LHCII complexes in mosses and algae [46, 47]. In obtaining excitation energy from a light trapping system [9, 44, 48], LHCSRs interact with other antenna system components, such as CP26 [49] or LHCBM1 [40, 50].

In addition to excess light, LHCSR3 was also observed to accumulate when the cells were exposed to carbon dioxide deprivation [19, 51] or high salinity or nitrogen starvation conditions [14]. Under the stress conditions mentioned above, reactive oxygen species are generated to an abundant level, which may activate the expression of LHCSRs (Figure 3). Without LHCSRs, the release of singlet oxygen is increased, which results in damage to PSII [52]. Therefore, the present evidence supports that there is a close relationship between LHCSRs and reactive oxygen species, and the fine-tuning mechanism still remains to be explored.



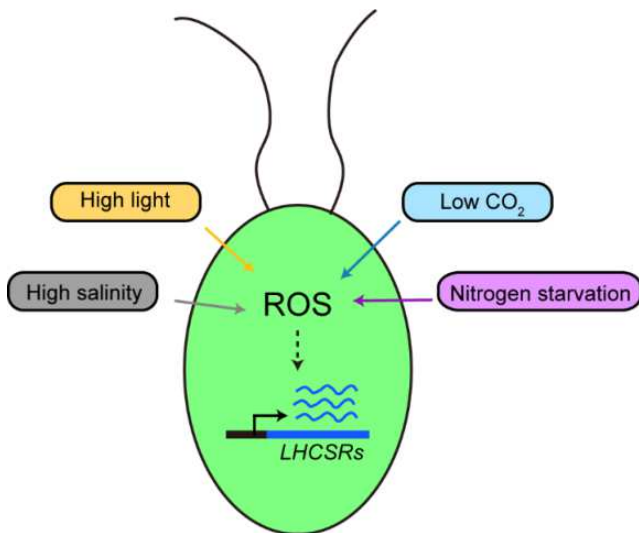

**Figure 3.** Schematic diagram showing the expression of *LHCSR3* activated by stress conditions. Under stress conditions, reactive oxygen species are generated at an abundant level, which may activate the expression of *LHCSR3*.

## 6. The Underlying Regulation Mechanism of *LHCSR3*

*LHCSR3* accumulates at various levels under high light stress, indicating that they are differentially regulated by the underlying mechanism. In particular, the transcripts of

*LHCSR3.1* and *LHCSR3.2* both accumulate at much higher levels than that of *LHCSR1*, suggesting that *LHCSR3* may play a more important role and be greatly upregulated under high light [53]. However, *LHCSR1* can partially compensate for the phenotype of the *Chlamydomonas npq4* mutant [5], demonstrating its role in NPQ, although it is not as important as *LHCSR3*. This evidence reveals that the expression of *LHCSR3* could be precisely regulated by the fine-tuning system.

Light signals and light utilization can be interlinked by *LHCSR3* and photoreceptors, which is supported by the evidence that both *LHCSR3* and qE are induced by ultraviolet light [54] and blue light [55], uncovering the relationship between light signals and energy utilization. Photoreceptors, such as UVR8 [54, 56] and phototropin (PHOT) [55], are required to induce the expression of *LHCSR3* and the occurrence of qE. Interestingly, the expression of *LHCSR3* is modulated by the photoreceptor PHOT and photosynthesis [19, 55, 57], while the expression of *LHCSR1* is controlled by UVR8 and is independent of photosynthesis [19]. Since ultraviolet light can damage both the PSI and PSII systems, *LHCSR1*, as the UVR8 responder, may participate in the quenching of both photosystems *in vivo* [46, 58, 59].

Once the light signal is captured by the photoreceptors, the downstream regulation of the *LHCSR3* is activated via the conserved E3 ubiquitin ligase complex through CrCO, which is homologous to the plant transcription factor (CONSTANS, CO) [60]. CrCO can be targeted by both the COP1-SPA1 and DET1-DDB1 pathways (Figure 4).

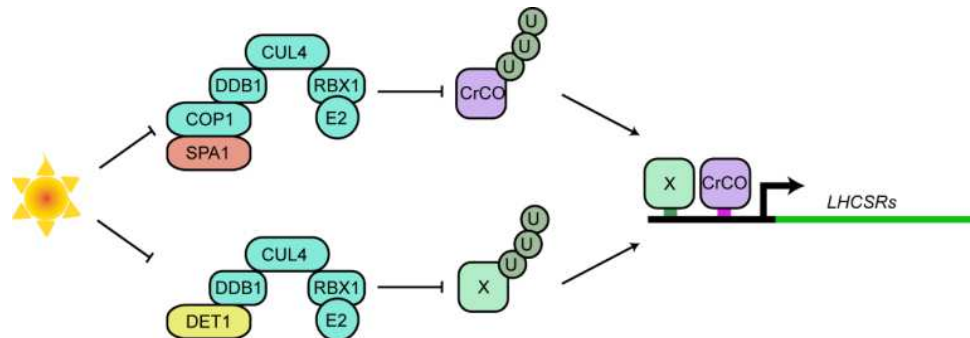

**Figure 4.** Schematic model of the expression of *LHCSR3* regulated by the ubiquitin ligase complex in *Chlamydomonas*. Under high light conditions, the activity of both the COP1-SPA1 E3 ubiquitin ligase and DDB1-DET1 E3 ubiquitin ligase is inhibited. This enables the accumulation of trans-acting factors and their binding to cis-acting elements to activate the transcription of *LHCSR3*, but the specific factor X remains to be identified. CUL4: a cullin-based ring-type ubiquitin E3 ligase complex type 4; RBX1: a small ring finger protein.

### 6.1. COP1-SPA1 Pathway

The expression of *LHCSR3* can be regulated in acclimation to various light conditions through the COP1-SPA1 pathway. Under low light conditions, CrCO can be ubiquitinated and degraded by the COP1-SPA1 E3 ubiquitin ligase complex in *Chlamydomonas*, which results in reduced expression of *LHCSR3* (*LHCSR1*, *LHCSR3.1* and *LHCSR3.2*). When algae are transferred to high light conditions, the COP1-SPA1 E3 ubiquitin ligase is inhibited by photoreceptor-mediated signaling through an unclear mechanism, which allows CrCO accumulation and binding with a CO-like binding motif, resulting in the activation of *LHCSR3* [61].

### 6.2. DET1-DDB1 Pathway

DDB1 (Cre10. g432000) and DET1 (Cre13. g571560) are two subunits of the CUL4-DDB1 DET1 E3 ligase complex, and their defects lead to the accumulated transcription of *LHCSR1* and *LHCSR3* in the dark, which is similar to the lack of CUL4<sup>COP1 SPA1</sup> [62]. The results from vascular plants and mammals indicate the possible mechanism of the CUL4-DDB1 DET1 system [63]. DDB1 and DET1 are thought to be part of the cullin-based ring E3 ubiquitin ligase complex 4 (CRL4). As a central scaffold subunit, the carboxyl termini of the Cullin protein bind to RBX1 (a small RING finger protein), and amino termini bind to the substrate

receptor module (e.g., DET1). The substrate receptor motif and the central scaffold subunit were connected by DDB1. The CRL4-DET1 complex (CRL4<sup>DET1</sup>) is an E3 ligase in *Arabidopsis* that negatively regulates the critical developmental stages in different organisms [64] or works in conjunction with another E3 ligase in regulating plant photomorphogenesis [65].

Both of the above E3 ligase complexes may target CrCO, or they may have different substrates to coregulate the expression of qE-related genes [62]. Thus, the expression of LHCSR is precisely regulated starting from the initial photoreception of the cells and throughout transcription, even though translation or posttranslation still remains to be identified.

## 7. Distribution and Evolution of LHCSRs in Algae

LHC proteins with three transmembrane helices are assumed to evolve from two-helix progenitors [66]. These LHC proteins may appear after the differentiation of green and red algae because there are no such proteins in glaucophytes [67]. LHCSRs have three transmembrane helices that are typical characteristics of the LHC superfamily, and they may follow the same evolutionary history.

LHCSRs are widely distributed in mosses, green algae, haptophytes, photosynthetic apicomplexan (*Chromera velia*) and photosynthetic stramenopiles [68] but absent in dinoflagellates [69], red algae, cryptophytes [70] and vascular plants [5]. Some reasons are suggested to explain the distribution pattern of LHCSRs mentioned above. Analysis of ancient origin suggests that LHCSRs are lost in red algae [71], but genes may transfer horizontally between green algae and secondary red algae, which is related to red plastid acquisition [72]. However, phylogenetic analysis indicates an opposite direction of gene transference, from red plastids containing lineages to green algae and plants [70]. This result is also supported by other studies [73, 74]. Although the timing seems questionable at first glance, Dittami *et al.* suggest that the window of opportunity occurred 200 million years ago [70] after secondary red algae and before green lineage diversification [36]. Therefore, the evolution of *LHCSRs* remains to be explored to explain their distribution in algae species.

LHCSR proteins have high efficiency in catalytic quenching reactions [5, 9]. However, in the course of evolution, they were replaced by PsbS. There are many differences between PsbS and LHCSR, such as quenching response mechanisms, thylakoid membrane localization, and interactions with other proteins. LHCSR has both quenching and pH sensing functions, while a single PsbS sensor can promote the quenching of multiple different LHC proteins [35]. PsbS is located in grana in mosses and vascular plants, [47, 75], concordant with its PSII quenching. However, LHCSR is limited to the stromal membrane [47], and the PSII supercomplex is quenched

directly by LHCSR only if it is exposed at the stromal margins. In algae and mosses, the overall proportion of PSII protected by LHCSR quenching is approximately 30%, and most of the PSII is unprotected [76]. Therefore, the localization of LHCSR in PSII-rich stromal membranes is not particularly suitable for protecting PSII under excessive light conditions.

In the stroma, PSI is quenched by LHCSR through LHCII [46, 47]. Although PSII reaction centers are limited to grana in mosses, LHCII is evenly distributed between stromal membranes and grana [47], and LHCII in stromal membranes helps regulate the size of the PSI antenna to offset the overreduction and charge recombination of PSII [77]. In green algae, LHCSR also transfers excitation energy to PSI through multiple LHCII complexes [78]. In summary, the main target of algal NPQ is PSI-associated LHCII of the stroma, which is colocalized with LHCSR.

Early land plants were directly exposed to sunlight [21], while with the emergence of vascular plants, the sunlight exposure of different plants depended on the degree of shading. Ultraviolet and blue light under shadows are consumed, and far-red and green light are enriched [79]. As the intensity and angle of sunlight change, plants may be exposed to suddenly increased light and produce photoinhibition effects [80]. The absorption efficiency of redshifted LHCI is much higher than that of LHCII, which reduces the overexcitation of PSI in high light, resulting in redundant LHCII and LHCSR in stromal membranes. PsbS can replace algae LHCSR and induce NPQ in vascular plants because both PsbS and PSII are located in the grana, where PsbS can enhance the photoprotective energy dissipation and repair rate of PSII [81]. In conclusion, during plant evolution, LHCSR was gradually replaced by PsbS, which is more suitable for terrestrial environments.

## 8. Future Research Prospects

Plant energy dissipation mechanisms limit growth but enhance photoprotection to avoid photoinhibition. Photosynthetic organisms have evolved the ability to dissipate excess solar energy as heat under high light conditions. A study has shown that under limited light, the biomass accumulation rates of *Arabidopsis thaliana* with insufficient or excessive energy dissipation increased or decreased, respectively, indicating an inverse relationship between energy dissipation and growth [82]. Additionally, increasing the NPQ relaxation rate of tobacco reduces its overall heat dissipation and significantly increases biomass yield under field conditions [83]. However, no consistent results have been obtained in studies of the energy dissipation of algae. Perozeni *et al.* found that *Chlamydomonas npq4* mutants grew faster than the wild type in photobioreactors [84], while other experiments showed the opposite results [53, 85].

In single-celled algae, energy dissipation is catalyzed by pigment-bound LHCSR proteins [9]. qE is induced by pigment-free PsbS proteins in higher plants [86-88]. LHCSR

and PsbS are located in different domains in the thylakoid membrane. PsbS and PSII are located together in the granum membrane [89-91], while LHCSR is located in the stromal membrane and can act on PSI and PSII [46, 47].

LHCSRs are the major components of NPQ in *Chlamydomonas* [5], and studies have been conducted to infer their physical and chemical properties [37, 42], stress response [20, 52], and gene regulatory mechanism [61, 62]. However, there are still many questions to be answered in understanding the action mechanism of LHCSRs. The expression of *LHCSRs* has been shown to be regulated from the initial photoreception to the transcription level, but the downstream regulatory network after transcription remains to be clarified. In particular, there is no information about the interacting proteins of LHCSRs at the translation level and transportation to the thylakoid membrane. Whether LHCSR could be transported into the thylakoid membrane in the liquid phase remains to be identified. How LHCSRs are degraded when cells are transferred from high light to low light needs to be explored.

With the development of synthetic biology, advanced technology, including artificial design, could be used to build an LHCSR scaffold with high catalytic activity efficiency. Meanwhile, synthetic promoters are also helpful for the precise regulation of LHCSR expression in response to environmental stress. Thus, specific strains could be developed with the LHCSR module being assembled to fulfil the requirements of practical application.

## 9. Conclusion

Excessive light is harmful to plants. This paper mainly introduces the involvement of *Chlamydomonas* LHCSRs in NPQ to consume excessive light energy to protect cells. Meanwhile, LHCSRs are also involved in other types of environmental stress. Therefore, this paper further reviewed the potential interaction factors and upstream regulatory factors of LHCSRs in *Chlamydomonas* and explored the potential mechanisms of LHCSRs in adaptation to various environmental stresses. By discussing the evolution of LHCSRs in green algae and mosses, we found that LHCSRs play an important role in plant adaptation to environmental changes on Earth. Future studies on LHCSRs could focus on the corresponding and regulatory mechanism of LHCSRs to other kinds of stress and apply it to synthetic biology to improve the resilience of food crops.

## Acknowledgements

This research was funded by the Tianjin Synthetic Biotechnology Innovation Capacity Improvement Project (TSBICIP-CXRC-027, TSBICIP-IJCP-001) and Science and Technology Partnership Program, Ministry of Science and Technology of China (KY202001017) to LZ. FJC was funded by the National Key R&D Program of China (2018YFE0107200, 2019YFA090460203).

## References

- [1] Nelson, N. & Ben-Shem, A. (2004). The complex architecture of oxygenic photosynthesis. *Nat Rev Mol Cell Biol*, 5 (12), 971-82. doi: 10.1038/nrm1525.
- [2] Rodolfi, L., Chini Zittelli, G., Bassi, N., Padovani, G., Biondi, N., Bonini, G. & Tredici, M. R. (2009). Microalgae for oil: strain selection, induction of lipid synthesis and outdoor mass cultivation in a low-cost photobioreactor. *Biotechnol Bioeng*, 102 (1), 100-12. doi: 10.1002/bit.22033.
- [3] Zhu, X. G., Long, S. P. & Ort, D. R. (2010). Improving photosynthetic efficiency for greater yield. *Annu Rev Plant Biol*, 61 (235-61). doi: 10.1146/annurev-arplant-042809-112206.
- [4] Stephenson, P. G., Moore, C. M., Terry, M. J., Zubkov, M. V. & Bibby, T. S. (2011). Improving photosynthesis for algal biofuels: toward a green revolution. *Trends Biotechnol*, 29 (12), 615-23. doi: 10.1016/j.tibtech.2011.06.005.
- [5] Peers, G., Truong, T. B., Ostendorf, E., Busch, A., Elrad, D., Grossman, A. R., Hippler, M. & Niyogi, K. K. (2009). An ancient light-harvesting protein is critical for the regulation of algal photosynthesis. *Nature*, 462 (7272), 518-21. doi: 10.1038/nature08587.
- [6] van Amerongen, H. & Croce, R. (2013). Light harvesting in photosystem II. *Photosynth Res*, 116 (2-3), 251-63. doi: 10.1007/s1120-013-9824-3.
- [7] Green, R. R. & Pichersky, E. (1994). Hypothesis for the evolution of three-helix Chl a/b and Chl a/c light-harvesting antenna proteins from two-helix and four-helix ancestors. *Photosynth Res*, 39 (2), 149-62. doi: 10.1007/bf00029382.
- [8] Triantaphylidès, C. & Havaux, M. (2009). Singlet oxygen in plants: production, detoxification and signaling. *Trends Plant Sci*, 14 (4), 219-28. doi: 10.1016/j.tplants.2009.01.008.
- [9] Bonente, G., Ballottari, M., Truong, T. B., Morosinotto, T., Ahn, T. K., Fleming, G. R., Niyogi, K. K. & Bassi, R. (2011). Analysis of LhcSR3, a protein essential for feedback de-excitation in the green alga *Chlamydomonas reinhardtii*. *PLoS Biol*, 9 (1), e1000577. doi: 10.1371/journal.pbio.1000577.
- [10] Gagné, G. & Guertin, M. (1992). The early genetic response to light in the green unicellular alga *Chlamydomonas eugametos* grown under light/dark cycles involves genes that represent direct responses to light and photosynthesis. *Plant Mol Biol*, 18 (3), 429-45. doi: 10.1007/bf00040659.
- [11] Savard, F., Richard, C. & Guertin, M. (1996). The *Chlamydomonas reinhardtii* LI818 gene represents a distant relative of the *cabI/II* genes that is regulated during the cell cycle and in response to illumination. *Plant Mol Biol*, 32 (3), 461-73. doi: 10.1007/bf00019098.
- [12] Richard, C., Ouellet, H. & Guertin, M. (2000). Characterization of the LI818 polypeptide from the green unicellular alga *Chlamydomonas reinhardtii*. *Plant Mol Biol*, 42 (2), 303-16. doi: 10.1023/a:1006340308077.
- [13] Li, X. P., Björkman, O., Shih, C., Grossman, A. R., Rosenquist, M., Jansson, S. & Niyogi, K. K. (2000). A pigment-binding protein essential for regulation of photosynthetic light harvesting. *Nature*, 403 (6768), 391-5. doi: 10.1038/35000131.

- [14] Tibiletti, T., Auroy, P., Peltier, G. & Caffarri, S. (2016). *Chlamydomonas reinhardtii* PsbS Protein Is Functional and Accumulates Rapidly and Transiently under High Light. *Plant Physiol*, 171 (4), 2717-30. doi: 10.1104/pp.16.00572.
- [15] Ledford, H. K., Baroli, I., Shin, J. W., Fischer, B. B., Eggen, R. I. & Niyogi, K. K. (2004). Comparative profiling of lipid-soluble antioxidants and transcripts reveals two phases of photo-oxidative stress in a xanthophyll-deficient mutant of *Chlamydomonas reinhardtii*. *Mol Genet Genomics*, 272 (4), 470-9. doi: 10.1007/s00438-004-1078-5.
- [16] Miura, K., Yamano, T., Yoshioka, S., Kohinata, T., Inoue, Y., Taniguchi, F., Asamizu, E., Nakamura, Y., Tabata, S., Yamato, K. T., Ohyama, K. & Fukuzawa, H. (2004). Expression profiling-based identification of CO<sub>2</sub>-responsive genes regulated by CCM1 controlling a carbon-concentrating mechanism in *Chlamydomonas reinhardtii*. *Plant Physiol*, 135 (3), 1595-607. doi: 10.1104/pp.104.041400.
- [17] Zhang, Z., Shrager, J., Jain, M., Chang, C. W., Vallon, O. & Grossman, A. R. (2004). Insights into the survival of *Chlamydomonas reinhardtii* during sulfur starvation based on microarray analysis of gene expression. *Eukaryot Cell*, 3 (5), 1331-48. doi: 10.1128/ec.3.5.1331-1348.2004.
- [18] Naumann, B., Busch, A., Allmer, J., Ostendorf, E., Zeller, M., Kirchhoff, H. & Hippler, M. (2007). Comparative quantitative proteomics to investigate the remodeling of bioenergetic pathways under iron deficiency in *Chlamydomonas reinhardtii*. *Proteomics*, 7 (21), 3964-79. doi: 10.1002/pmic.200700407.
- [19] Maruyama, S., Tokutsu, R. & Minagawa, J. (2014). Transcriptional regulation of the stress-responsive light harvesting complex genes in *Chlamydomonas reinhardtii*. *Plant Cell Physiol*, 55 (7), 1304-10. doi: 10.1093/pcp/pcu068.
- [20] Perozeni, F., Beghini, G., Cazzaniga, S. & Ballottari, M. (2020). *Chlamydomonas reinhardtii* LHCSR1 and LHCSR3 proteins involved in photoprotective non-photochemical quenching have different quenching efficiency and different carotenoid affinity. *Sci Rep*, 10 (1), 21957. doi: 10.1038/s41598-020-78985-w.
- [21] Delwiche, C. F. & Cooper, E. D. (2015). The Evolutionary Origin of a Terrestrial Flora. *Curr Biol*, 25 (19), R899-910. doi: 10.1016/j.cub.2015.08.029.
- [22] Kohzuma, K. & Hikosaka, K. (2018). Physiological validation of photochemical reflectance index (PRI) as a photosynthetic parameter using *Arabidopsis thaliana* mutants. *Biochem Biophys Res Commun*, 498 (1), 52-57. doi: 10.1016/j.bbrc.2018.02.192.
- [23] Niyogi, K. K. (1999). PHOTOPROTECTION REVISITED: Genetic and Molecular Approaches. *Annu Rev Plant Physiol Plant Mol Biol*, 50 (333-359). doi: 10.1146/annurev.arplant.50.1.333.
- [24] Nilkens, M., Kress, E., Lambrev, P., Miloslavina, Y., Müller, M., Holzwarth, A. R. & Jahns, P. (2010). Identification of a slowly inducible zeaxanthin-dependent component of non-photochemical quenching of chlorophyll fluorescence generated under steady-state conditions in *Arabidopsis*. *Biochim Biophys Acta*, 1797 (4), 466-75. doi: 10.1016/j.bbabi.2010.01.001.
- [25] Caffarri, S., Frigerio, S., Olivieri, E., Righetti, P. G. & Bassi, R. (2005). Differential accumulation of Lhcb gene products in thylakoid membranes of *Zea mays* plants grown under contrasting light and temperature conditions. *Proteomics*, 5 (3), 758-68. doi: 10.1002/pmic.200402008.
- [26] Färber, A. & Jahns, P. (1998). The xanthophyll cycle of higher plants: influence of antenna size and membrane organization. *Biochim Biophys Acta*, 1363 (1), 47-58. doi: 10.1016/s0005-2728(97)00093-5.
- [27] Morosinotto, T., Castelletti, S., Breton, J., Bassi, R. & Croce, R. (2002). Mutation analysis of Lhca1 antenna complex. Low energy absorption forms originate from pigment-pigment interactions. *J Biol Chem*, 277 (39), 36253-61. doi: 10.1074/jbc.M205062200.
- [28] Dall'Osto, L., Lico, C., Alric, J., Giuliano, G., Havaux, M. & Bassi, R. (2006). Lutein is needed for efficient chlorophyll triplet quenching in the major LHCII antenna complex of higher plants and effective photoprotection in vivo under strong light. *BMC Plant Biol*, 6 (32). doi: 10.1186/1471-2229-6-32.
- [29] Jahns, P., Latowski, D. & Strzalka, K. (2009). Mechanism and regulation of the violaxanthin cycle: the role of antenna proteins and membrane lipids. *Biochim Biophys Acta*, 1787 (1), 3-14. doi: 10.1016/j.bbabi.2008.09.013.
- [30] Bugos, R. C., Hieber, A. D. & Yamamoto, H. Y. (1998). Xanthophyll cycle enzymes are members of the lipocalin family, the first identified from plants. *J Biol Chem*, 273 (25), 15321-4. doi: 10.1074/jbc.273.25.15321.
- [31] Goss, R. & Latowski, D. (2020). Lipid Dependence of Xanthophyll Cycling in Higher Plants and Algae. *Front Plant Sci*, 11 (455). doi: 10.3389/fpls.2020.00455.
- [32] Quaas, T., Berteotti, S., Ballottari, M., Flieger, K., Bassi, R., Wilhelm, C. & Goss, R. (2015). Non-photochemical quenching and xanthophyll cycle activities in six green algal species suggest mechanistic differences in the process of excess energy dissipation. *J Plant Physiol*, 172 (92-103). doi: 10.1016/j.jplph.2014.07.023.
- [33] Masojidek, J., Kopecký, J., Koblizek, M. & Torzillo, G. (2004). The xanthophyll cycle in green algae (chlorophyta): its role in the photosynthetic apparatus. *Plant Biol (Stuttg)*, 6 (3), 342-9. doi: 10.1055/s-2004-820884.
- [34] Alboresi, A., Gerotto, C., Giacometti, G. M., Bassi, R. & Morosinotto, T. (2010). Physcomitrella patens mutants affected on heat dissipation clarify the evolution of photoprotection mechanisms upon land colonization. *Proc Natl Acad Sci U S A*, 107 (24), 11128-33. doi: 10.1073/pnas.1002873107.
- [35] Niyogi, K. K. & Truong, T. B. (2013). Evolution of flexible non-photochemical quenching mechanisms that regulate light harvesting in oxygenic photosynthesis. *Curr Opin Plant Biol*, 16 (3), 307-14. doi: 10.1016/j.pbi.2013.03.011.
- [36] Pinnola, A. (2019). The rise and fall of Light-Harvesting Complex Stress-Related proteins as photoprotection agents during evolution. *J Exp Bot*, 70 (20), 5527-5535. doi: 10.1093/jxb/erz317.
- [37] Bergner, S. V., Scholz, M., Trompelt, K., Barth, J., Gäbelein, P., Steinbeck, J., Xue, H., Clowez, S., Fucile, G., Goldschmidt-Clermont, M., Fufezan, C. & Hippler, M. (2015). STATE TRANSITION7-Dependent Phosphorylation Is Modulated by Changing Environmental Conditions, and Its Absence Triggers Remodeling of Photosynthetic Protein Complexes. *Plant Physiol*, 168 (2), 615-34. doi: 10.1104/pp.15.00072.
- [38] Allorent, G., Tokutsu, R., Roach, T., Peers, G., Cardol, P., Girard-Bascou, J., Seigneurin-Berny, D., Petroustos, D., Kuntz, M., Breyton, C., Franck, F., Wollman, F. A., Niyogi, K. K., Krieger-Liszka, A., Minagawa, J. & Finazzi, G. (2013). A dual strategy to cope with high light in *Chlamydomonas reinhardtii*. *Plant Cell*, 25 (2), 545-57. doi: 10.1105/tpc.112.108274.



- [39] de la Cruz Valbuena, G., F. V. A. C., Borrego-Varillas, R., Perozeni, F., D'Andrea, C., Ballottari, M. & Cerullo, G. (2019). Molecular Mechanisms of Nonphotochemical Quenching in the LHCSR3 Protein of *Chlamydomonas reinhardtii*. *J Phys Chem Lett*, 10 (10), 2500-2505. doi: 10.1021/acs.jpclett.9b01184.
- [40] Tokutsu, R. & Minagawa, J. (2013). Energy-dissipative supercomplex of photosystem II associated with LHCSR3 in *Chlamydomonas reinhardtii*. *Proc Natl Acad Sci U S A*, 110 (24), 10016-21. doi: 10.1073/pnas.1222606110.
- [41] Perozeni, F., Cazzaniga, S. & Ballottari, M. (2019). In vitro and in vivo investigation of chlorophyll binding sites involved in non-photochemical quenching in *Chlamydomonas reinhardtii*. *Plant Cell Environ*, 42 (8), 2522-2535. doi: 10.1111/pce.13566.
- [42] Pinnola, A., Ballottari, M., Bargigia, I., Alcocer, M., D'Andrea, C., Cerullo, G. & Bassi, R. (2017). Functional modulation of LHCSR1 protein from *Physcomitrella patens* by zeaxanthin binding and low pH. *Sci Rep*, 7 (1), 11158. doi: 10.1038/s41598-017-11101-7.
- [43] Joliot, P. A. & Finazzi, G. (2010). Proton equilibration in the chloroplast modulates multiphasic kinetics of nonphotochemical quenching of fluorescence in plants. *Proc Natl Acad Sci U S A*, 107 (28), 12728-33. doi: 10.1073/pnas.1006399107.
- [44] Liguori, N., Roy, L. M., Opacic, M., Durand, G. & Croce, R. (2013). Regulation of light harvesting in the green alga *Chlamydomonas reinhardtii*: the C-terminus of LHCSR is the knob of a dimmer switch. *J Am Chem Soc*, 135 (49), 18339-42. doi: 10.1021/ja4107463.
- [45] Girolomoni, L., Ferrante, P., Berteotti, S., Giuliano, G., Bassi, R. & Ballottari, M. (2017). The function of LHCBM4/6/8 antenna proteins in *Chlamydomonas reinhardtii*. *J Exp Bot*, 68 (3), 627-641. doi: 10.1093/jxb/erw462.
- [46] Girolomoni, L., Cazzaniga, S., Pinnola, A., Perozeni, F., Ballottari, M. & Bassi, R. (2019). LHCSR3 is a nonphotochemical quencher of both photosystems in *Chlamydomonas reinhardtii*. *Proc Natl Acad Sci U S A*, 116 (10), 4212-4217. doi: 10.1073/pnas.1809812116.
- [47] Pinnola, A., Cazzaniga, S., Alboresi, A., Nevo, R., Levin-Zaidman, S., Reich, Z. & Bassi, R. (2015). Light-Harvesting Complex Stress-Related Proteins Catalyze Excess Energy Dissipation in Both Photosystems of *Physcomitrella patens*. *Plant Cell*, 27 (11), 3213-27. doi: 10.1105/tpc.15.00443.
- [48] Ferrante, P., Ballottari, M., Bonente, G., Giuliano, G. & Bassi, R. (2012). LHCBM1 and LHCBM2/7 polypeptides, components of major LHCII complex, have distinct functional roles in photosynthetic antenna system of *Chlamydomonas reinhardtii*. *J Biol Chem*, 287 (20), 16276-88. doi: 10.1074/jbc.M111.316729.
- [49] Semchonok, D. A., Sathish Yadav, K. N., Xu, P., Drop, B., Croce, R. & Boekema, E. J. (2017). Interaction between the photoprotective protein LHCSR3 and C(2)S(2) Photosystem II supercomplex in *Chlamydomonas reinhardtii*. *Biochim Biophys Acta Bioenerg*, 1858 (5), 379-385. doi: 10.1016/j.bbabi.2017.02.015.
- [50] Elrad, D., Niyogi, K. K. & Grossman, A. R. (2002). A major light-harvesting polypeptide of photosystem II functions in thermal dissipation. *Plant Cell*, 14 (8), 1801-16. doi: 10.1105/tpc.002154.
- [51] Dang, K. V., Plet, J., Tolleter, D., Jokel, M., Cuiné, S., Carrier, P., Auroy, P., Richaud, P., Johnson, X., Alric, J., Allahverdiyeva, Y. & Peltier, G. (2014). Combined increases in mitochondrial cooperation and oxygen photoreduction compensate for deficiency in cyclic electron flow in *Chlamydomonas reinhardtii*. *Plant Cell*, 26 (7), 3036-50. doi: 10.1105/tpc.114.126375.
- [52] Barera, S., Dall'Osto, L. & Bassi, R. (2021). Effect of lhcsr gene dosage on oxidative stress and light use efficiency by *Chlamydomonas reinhardtii* cultures. *J Biotechnol*, 328 (12-22). doi: 10.1016/j.jbiotec.2020.12.023.
- [53] Cantrell, M. & Peers, G. (2017). A mutant of *Chlamydomonas* without LHCSR maintains high rates of photosynthesis, but has reduced cell division rates in sinusoidal light conditions. *PLoS One*, 12 (6), e0179395. doi: 10.1371/journal.pone.0179395.
- [54] Alloreant, G., Lefebvre-Legendre, L., Chappuis, R., Kuntz, M., Truong, T. B., Niyogi, K. K., Ulm, R. & Goldschmidt-Clermont, M. (2016). UV-B photoreceptor-mediated protection of the photosynthetic machinery in *Chlamydomonas reinhardtii*. *Proc Natl Acad Sci U S A*, 113 (51), 14864-14869. doi: 10.1073/pnas.1607695114.
- [55] Petroustos, D., Tokutsu, R., Maruyama, S., Flori, S., Greiner, A., Magneschi, L., Cusant, L., Kottke, T., Mittag, M., Hegemann, P., Finazzi, G. & Minagawa, J. (2016). A blue-light photoreceptor mediates the feedback regulation of photosynthesis. *Nature*, 537 (7621), 563-566. doi: 10.1038/nature19358.
- [56] Tilbrook, K., Dubois, M., Crocco, C. D., Yin, R., Chappuis, R., Alloreant, G., Schmid-Siebert, E., Goldschmidt-Clermont, M. & Ulm, R. (2016). UV-B Perception and Acclimation in *Chlamydomonas reinhardtii*. *Plant Cell*, 28 (4), 966-83. doi: 10.1105/tpc.15.00287.
- [57] Petroustos, D., Busch, A., Janssen, I., Trompelt, K., Bergner, S. V., Weinl, S., Holtkamp, M., Karst, U., Kudla, J. & Hippler, M. (2011). The chloroplast calcium sensor CAS is required for photoacclimation in *Chlamydomonas reinhardtii*. *Plant Cell*, 23 (8), 2950-63. doi: 10.1105/tpc.111.087973.
- [58] Dinc, E., Tian, L., Roy, L. M., Roth, R., Goodenough, U. & Croce, R. (2016). LHCSR1 induces a fast and reversible pH-dependent fluorescence quenching in LHCII in *Chlamydomonas reinhardtii* cells. *Proc Natl Acad Sci U S A*, 113 (27), 7673-8. doi: 10.1073/pnas.1605380113.
- [59] Kosuge, K., Tokutsu, R., Kim, E., Akimoto, S., Yokono, M., Ueno, Y. & Minagawa, J. (2018). LHCSR1-dependent fluorescence quenching is mediated by excitation energy transfer from LHCII to photosystem I in *Chlamydomonas reinhardtii*. *Proc Natl Acad Sci U S A*, 115 (14), 3722-3727. doi: 10.1073/pnas.1720574115.
- [60] Serrano, G., Herrera-Palau, R., Romero, J. M., Serrano, A., Coupland, G. & Valverde, F. (2009). *Chlamydomonas* CONSTANS and the evolution of plant photoperiodic signaling. *Curr Biol*, 19 (5), 359-68. doi: 10.1016/j.cub.2009.01.044.
- [61] Gabilly, S. T., Baker, C. R., Wakao, S., Crisanto, T., Guan, K., Bi, K., Guet, E., Guadagno, C. R. & Niyogi, K. K. (2019). Regulation of photoprotection gene expression in *Chlamydomonas* by a putative E3 ubiquitin ligase complex and a homolog of CONSTANS. *Proc Natl Acad Sci U S A*, 116 (35), 17556-17562. doi: 10.1073/pnas.1821689116.
- [62] Aihara, Y., Fujimura-Kamada, K., Yamasaki, T. & Minagawa, J. (2019). Algal photoprotection is regulated by the E3 ligase CUL4-DDB1 (DET1). *Nat Plants*, 5 (1), 34-40. doi: 10.1038/s41477-018-0332-5.

- [63] Lau, O. S. & Deng, X. W. (2012). The photomorphogenic repressors COP1 and DET1: 20 years later. *Trends Plant Sci*, 17 (10), 584-93. doi: 10.1016/j.tplants.2012.05.004.
- [64] Bernhardt, A., Lechner, E., Hano, P., Schade, V., Dieterle, M., Anders, M., Dubin, M. J., Benvenuto, G., Bowler, C., Genschik, P. & Hellmann, H. (2006). CUL4 associates with DDB1 and DET1 and its downregulation affects diverse aspects of development in *Arabidopsis thaliana*. *Plant J*, 47 (4), 591-603. doi: 10.1111/j.1365-3113X.2006.02810.x.
- [65] Chen, H., Shen, Y., Tang, X., Yu, L., Wang, J., Guo, L., Zhang, Y., Zhang, H., Feng, S., Strickland, E., Zheng, N. & Deng, X. W. (2006). *Arabidopsis* CULLIN4 Forms an E3 Ubiquitin Ligase with RBX1 and the CDD Complex in Mediating Light Control of Development. *Plant Cell*, 18 (8), 1991-2004. doi: 10.1105/tpc.106.043224.
- [66] Engelken, J., Brinkmann, H. & Adamska, I. (2010). Taxonomic distribution and origins of the extended LHC (light-harvesting complex) antenna protein superfamily. *BMC Evol Biol*, 10 (233). doi: 10.1186/1471-2148-10-233.
- [67] Price, D. C., Chan, C. X., Yoon, H. S., Yang, E. C., Qiu, H., Weber, A. P., Schwacke, R., Gross, J., Blouin, N. A., Lane, C., Reyes-Prieto, A., Durnford, D. G., Neilson, J. A., Lang, B. F., Burger, G., Steiner, J. M., Löffelhardt, W., Meuser, J. E., Posewitz, M. C., Ball, S., Arias, M. C., Henrissat, B., Coutinho, P. M., Rensing, S. A., Symeonidi, A., Doddapaneni, H., Green, B. R., Rajah, V. D., Boore, J. & Bhattacharya, D. (2012). *Cyanophora paradoxa* genome elucidates origin of photosynthesis in algae and plants. *Science*, 335 (6070), 843-7. doi: 10.1126/science.1213561.
- [68] Pan, H., Slapeta, J., Carter, D. & Chen, M. (2012). Phylogenetic analysis of the light-harvesting system in *Chromera velia*. *Photosynth Res*, 111 (1-2), 19-28. doi: 10.1007/s11120-011-9710-9.
- [69] Boldt, L., Yellowlees, D. & Leggat, W. (2012). Hyperdiversity of genes encoding integral light-harvesting proteins in the dinoflagellate *Symbiodinium* sp. *PLoS One*, 7 (10), e47456. doi: 10.1371/journal.pone.0047456.
- [70] Dittami, S. M., Michel, G., Collén, J., Boyen, C. & Tonon, T. (2010). Chlorophyll-binding proteins revisited--a multigenic family of light-harvesting and stress proteins from a brown algal perspective. *BMC Evol Biol*, 10 (365). doi: 10.1186/1471-2148-10-365.
- [71] Koziol, A. G., Borza, T., Ishida, K., Keeling, P., Lee, R. W. & Durnford, D. G. (2007). Tracing the evolution of the light-harvesting antennae in chlorophyll a/b-containing organisms. *Plant Physiol*, 143 (4), 1802-16. doi: 10.1104/pp.106.092536.
- [72] Frommolt, R., Werner, S., Paulsen, H., Goss, R., Wilhelm, C., Zauner, S., Maier, U. G., Grossman, A. R., Bhattacharya, D. & Lohr, M. (2008). Ancient recruitment by chromists of green algal genes encoding enzymes for carotenoid biosynthesis. *Mol Biol Evol*, 25 (12), 2653-67. doi: 10.1093/molbev/msn206.
- [73] Hoffman, G. E., Sanchez Puerta, M. V. & Delwiche, C. F. (2011). Evolution of light-harvesting complex proteins from Chl c-containing algae. *BMC Evol Biol*, 11 (101). doi: 10.1186/1471-2148-11-101.
- [74] Vieler, A., Wu, G., Tsai, C. H., Bullard, B., Cornish, A. J., Harvey, C., Reca, I. B., Thornburg, C., Achawanantakun, R., Buehl, C. J., Campbell, M. S., Cavalier, D., Childs, K. L., Clark, T. J., Deshpande, R., Erickson, E., Armenia Ferguson, A., Handee, W., Kong, Q., Li, X., Liu, B., Lundback, S., Peng, C., Roston, R. L., Sanjaya, Simpson, J. P., Terbush, A., Warakanont, J., Zäuner, S., Farre, E. M., Hegg, E. L., Jiang, N., Kuo, M. H., Lu, Y., Niyogi, K. K., Ohlrogge, J., Osteryoung, K. W., Shachar-Hill, Y., Sears, B. B., Sun, Y., Takahashi, H., Yandell, M., Shiu, S. H. & Benning, C. (2012). Genome, functional gene annotation, and nuclear transformation of the heterokont oleaginous alga *Nannochloropsis oceanica* CCMP1779. *PLoS Genet*, 8 (11), e1003064. doi: 10.1371/journal.pgen.1003064.
- [75] Suorsa, M., Rantala, M., Danielsson, R., Järvi, S., Paakkarinen, V., Schröder, W. P., Styring, S., Mamedov, F. & Aro, E. M. (2014). Dark-adapted spinach thylakoid protein heterogeneity offers insights into the photosystem II repair cycle. *Biochim Biophys Acta*, 1837 (9), 1463-71. doi: 10.1016/j.bbabo.2013.11.014.
- [76] Amarnath, K., Bennett, D. I., Schneider, A. R. & Fleming, G. R. (2016). Multiscale model of light harvesting by photosystem II in plants. *Proc Natl Acad Sci U S A*, 113 (5), 1156-61. doi: 10.1073/pnas.1524999113.
- [77] Pinnola, A. & Bassi, R. (2018). Molecular mechanisms involved in plant photoprotection. *Biochem Soc Trans*, 46 (2), 467-482. doi: 10.1042/bst20170307.
- [78] Bos, I., Bland, K. M., Tian, L., Croce, R., Frankel, L. K., van Amerongen, H., Bricker, T. M. & Wientjes, E. (2017). Multiple LHCII antennae can transfer energy efficiently to a single Photosystem I. *Biochim Biophys Acta Bioenerg*, 1858 (5), 371-378. doi: 10.1016/j.bbabo.2017.02.012.
- [79] Ballaré, C. L. & Pierik, R. (2017). The shade-avoidance syndrome: multiple signals and ecological consequences. *Plant Cell Environ*, 40 (11), 2530-2543. doi: 10.1111/pce.12914.
- [80] Tian, Y., Sacharz, J., Ware, M. A., Zhang, H. & Ruban, A. V. (2017). Effects of periodic photoinhibitory light exposure on physiology and productivity of *Arabidopsis* plants grown under low light. *J Exp Bot*, 68 (15), 4249-4262. doi: 10.1093/jxb/erx213.
- [81] Johnson, M. P., Goral, T. K., Duffy, C. D., Brain, A. P., Mullineaux, C. W. & Ruban, A. V. (2011). Photoprotective energy dissipation involves the reorganization of photosystem II light-harvesting complexes in the grana membranes of spinach chloroplasts. *Plant Cell*, 23 (4), 1468-79. doi: 10.1105/tpc.110.081646.
- [82] Dall'Osto, L., Caffarri, S. & Bassi, R. (2005). A mechanism of nonphotochemical energy dissipation, independent from PsbS, revealed by a conformational change in the antenna protein CP26. *Plant Cell*, 17(4), 1217-32. doi: 10.1105/tpc.104.030601.
- [83] Kromdijk, J., Glowacka, K., Leonelli, L., Gabilly, S. T., Iwai, M., Niyogi, K. K. & Long, S. P. (2016). Improving photosynthesis and crop productivity by accelerating recovery from photoprotection. *Science*, 354 (6314), 857-861. doi: 10.1126/science.aai8878.
- [84] Perozeni, F., Stella, G. R. & Ballottari, M. (2018). LHCSR Expression under HSP70/RBCS2 Promoter as a Strategy to Increase Productivity in Microalgae. *Int J Mol Sci*, 19 (1), doi: 10.3390/ijms19010155.
- [85] Chaux, F., Johnson, X., Auroy, P., Beyly-Adriano, A., Te, I., Cuiné, S. & Peltier, G. (2017). PGRL1 and LHCSR3 Compensate for Each Other in Controlling Photosynthesis and Avoiding Photosystem I Photoinhibition during High Light Acclimation of *Chlamydomonas* Cells. *Mol Plant*, 10 (1), 216-218. doi: 10.1016/j.molp.2016.09.005.

- [86] Li, X. P., Phippard, A., Pasari, J. & Niyogi, K. K. (2002). Structure-function analysis of photosystem II subunit S (PsbS) in vivo. *Funct Plant Biol*, 29 (10), 1131-1139. doi: 10.1071/fp02065.
- [87] Dominici, P., Caffarri, S., Armenante, F., Ceoldo, S., Crimi, M. & Bassi, R. (2002). Biochemical properties of the PsbS subunit of photosystem II either purified from chloroplast or recombinant. *J Biol Chem*, 277 (25), 22750-8. doi: 10.1074/jbc.M200604200.
- [88] Fan, M., Li, M., Liu, Z., Cao, P., Pan, X., Zhang, H., Zhao, X., Zhang, J. & Chang, W. (2015). Crystal structures of the PsbS protein essential for photoprotection in plants. *Nat Struct Mol Biol*, 22 (9), 729-35. doi: 10.1038/nsmb.3068.
- [89] Redekop, P., Rothhausen, N., Rothhausen, N., Melzer, M., Mosebach, L., Dülger, E., Bovdilova, A., Caffarri, S., Hippler, M. & Jahns, P. (2020). PsbS contributes to photoprotection in *Chlamydomonas reinhardtii* independently of energy dissipation. *Biochim Biophys Acta Bioenerg*, 1861 (5-6), 148183. doi: 10.1016/j.bbabo.2020.148183.
- [90] Pinnola, A., Ghin, L., Gecchele, E., Merlin, M., Alboresi, A., Avesani, L., Pezzotti, M., Capaldi, S., Cazzaniga, S. & Bassi, R. (2015). Heterologous expression of moss light-harvesting complex stress-related 1 (LHCSR1), the chlorophyll a-xanthophyll pigment-protein complex catalyzing non-photochemical quenching, in *Nicotiana sp.* *J Biol Chem*, 290 (40), 24340-54. doi: 10.1074/jbc.M115.668798.
- [91] Dikaio, I., Schiphorst, C., Dall'Osto, L., Alboresi, A., Bassi, R. & Pinnola, A. (2019). Functional analysis of LHCSR1, a protein catalyzing NPQ in mosses, by heterologous expression in *Arabidopsis thaliana*. *Photosynth Res*, 142 (3), 249-264. doi: 10.1007/s11120-019-00656-3.